

# SQUARE, 2 DOOR RETROFIT MANHOLE SURVEY FORM

ALL FIELDS MUST BE FILLED IN. COMPLETE 1 SHEET PER TANK.

ENGINEER: \_\_\_\_\_ SURVEY DATE: \_\_\_\_\_

CONTRACTOR NAME: \_\_\_\_\_ STATION #: \_\_\_\_\_

STATION ADDRESS(LOCATION): \_\_\_\_\_

PURCHASE ORDER NO.: \_\_\_\_\_ **CNI RETROFIT PART NO.:** \_\_\_\_\_

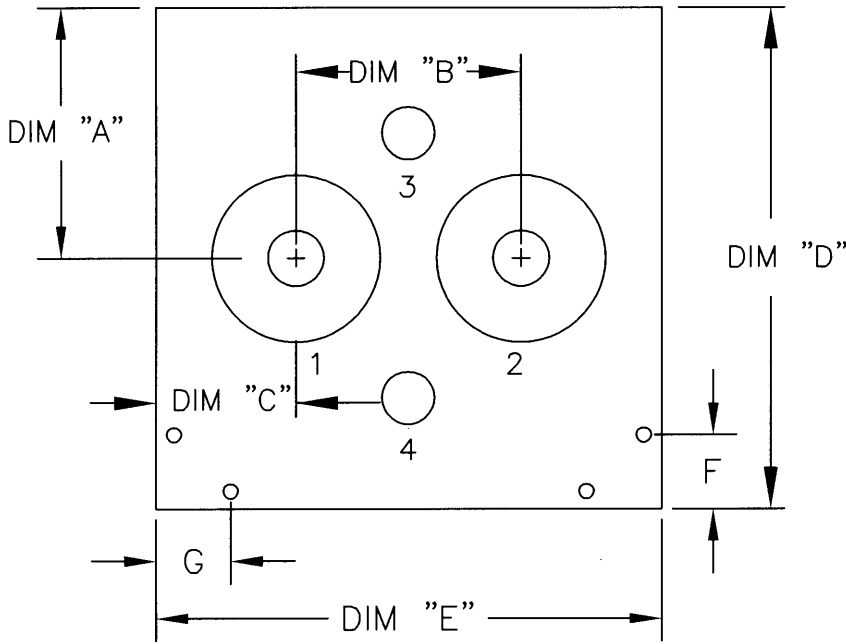

**NOTE:**

- \* **12" Observation port available ONLY on 42" and 48" manholes**
- \* **Minimum for DIM "B"**
- 14.25" for Snap-tight covers**
- 14.75" for Gravity covers**

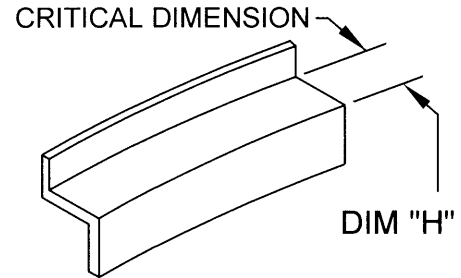

**ROLLED STEEL RING**

1. DIM "A": \_\_\_\_\_
2. DIM "B": \_\_\_\_\_
3. DIM "C": \_\_\_\_\_
4. DIM "D": \_\_\_\_\_
5. DIM "E": \_\_\_\_\_
6. DIM "F": CAM-LOK \_\_\_\_\_
7. DIM "G": CAM-LOK \_\_\_\_\_
8. DIM "H": WIDTH \_\_\_\_\_
9. #1 (PRODUCT NAME): \_\_\_\_\_
10. #2 (PRODUCT NAME): \_\_\_\_\_

**(CIRCLE ONE)**  
11. OBSERV. PORT: 7"-OOCL7 - 12"-OOCL12

**(CIRCLE ONE)**  
12. OBSERV. PORT: 3 - 4  
**(SEE NOTE, ABOVE)**

**(CIRCLE ONE)**  
13. ACCESS COVERS NEEDED:  
SNAP-TIGHT COVERS OR GRAVITY COVERS

**(CHECK BOXES THAT APPLY)**  
14. SPILL CONTAINERS NEEDED:  
FILL SIDE: YES  NO  VAPOR SIDE: YES  NO